

EVOLUTION

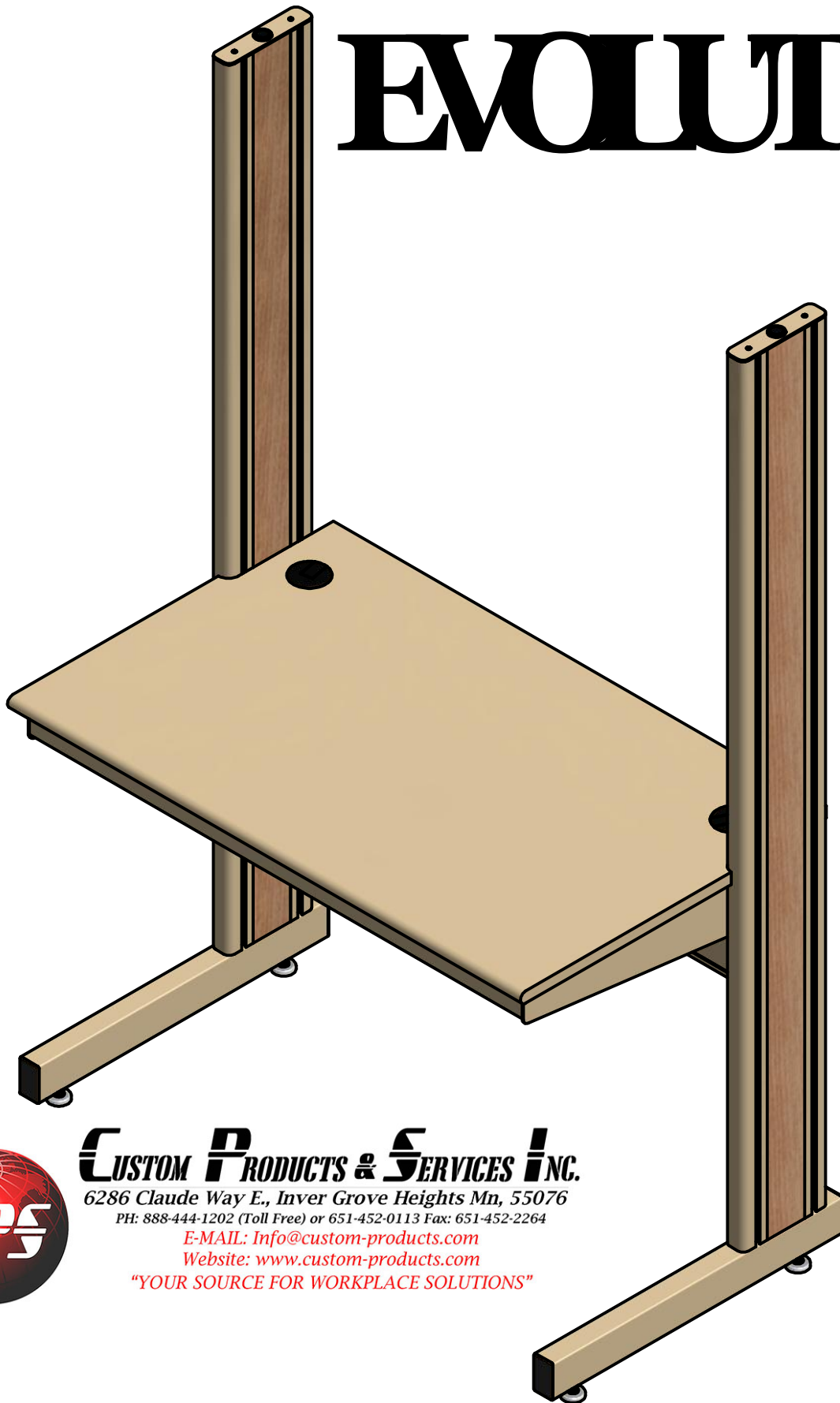

CUSTOM PRODUCTS & SERVICES INC.

6286 Claude Way E., Inver Grove Heights Mn, 55076

PH: 888-444-1202 (Toll Free) or 651-452-0113 Fax: 651-452-2264

E-MAIL: Info@custom-products.com

Website: www.custom-products.com

"YOUR SOURCE FOR WORKPLACE SOLUTIONS"

Parts List



Work Surface x 1

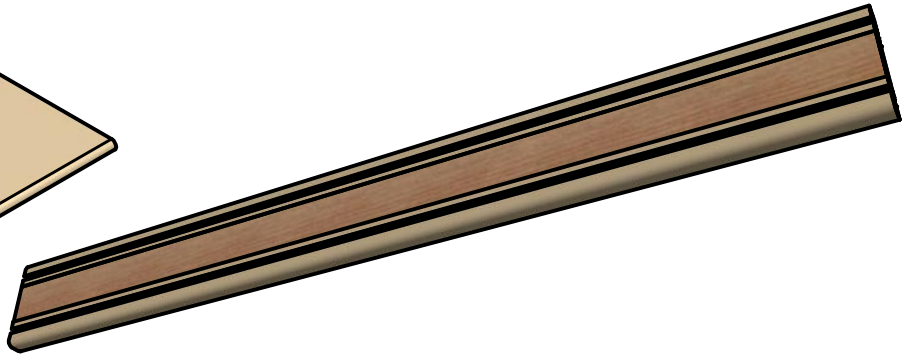

Column x 2

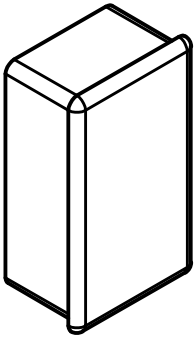

Column Leg Insert x 4

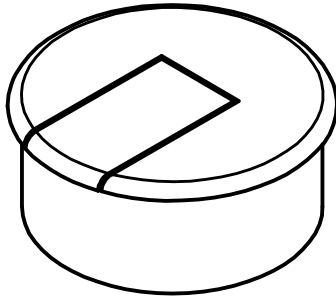

Work Surface Power Insert x 2

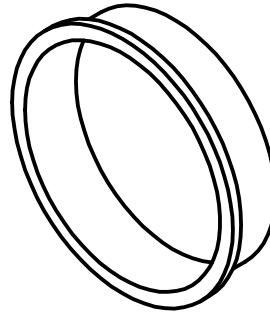

Modesty Panel Insert x 2

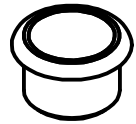

Column Cap Insert x 2

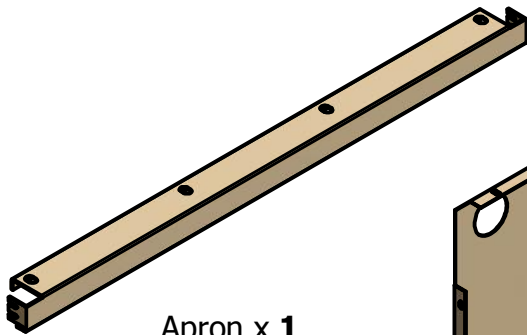

Apron x 1

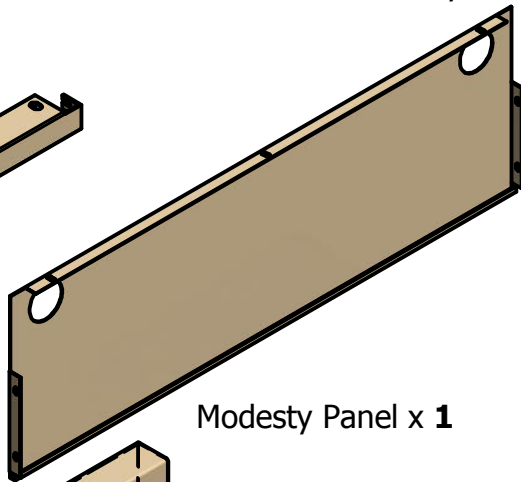

Modesty Panel x 1

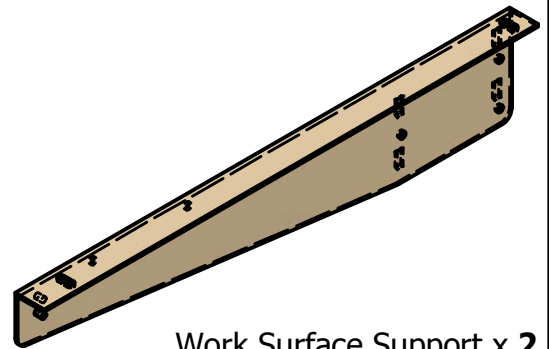

Work Surface Support x 2

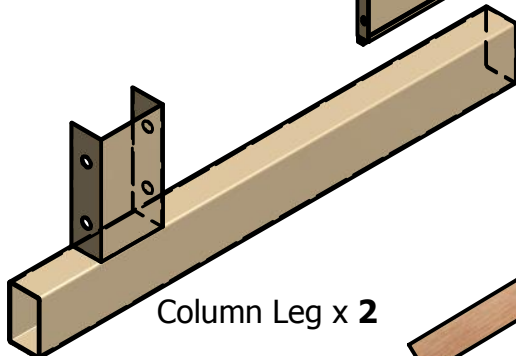

Column Leg x 2

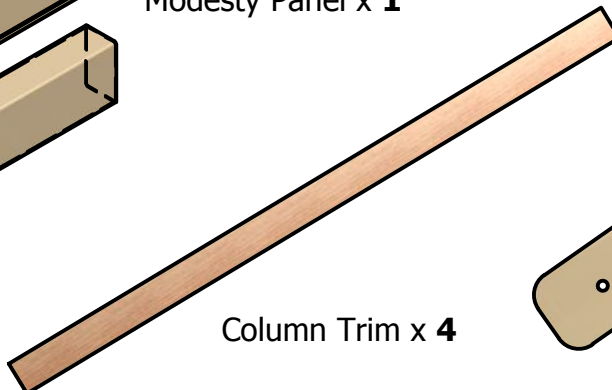

Column Trim x 4

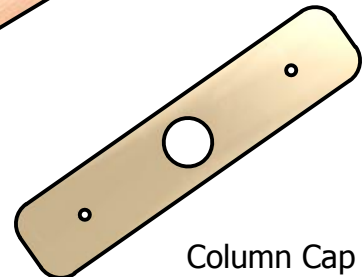

Column Cap x 2

Parts List

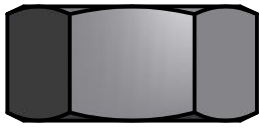

970014
5/16 Hex Nut
Qty. 14

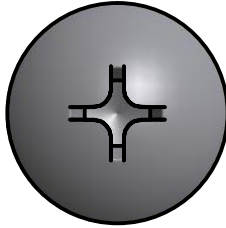

970301
1/4-20 Phillips Bolt
Qty. 9

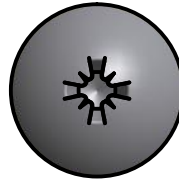

400009
6x3/8 Phillips screw
Qty. 4

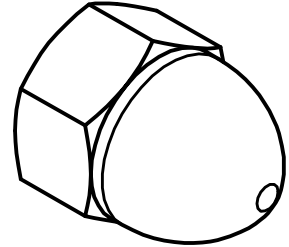

970405
5/16-18 Black Acorn Nut
Qty. 4

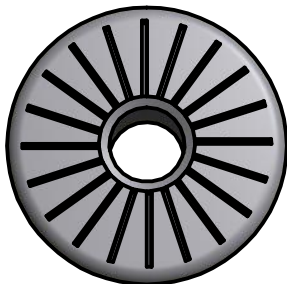
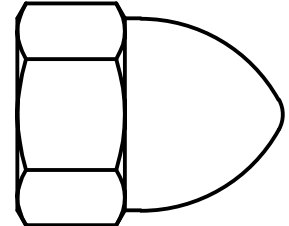
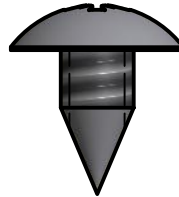
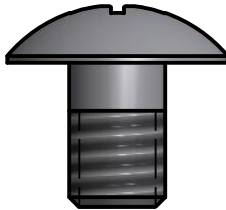
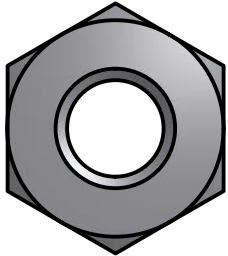

970434
1/4-20 Tensilock Nut
Qty. 4

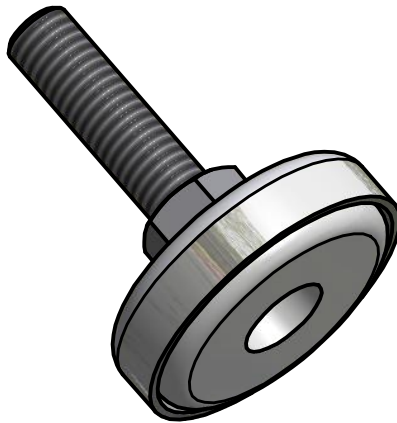

990781
Leveling Glide
Qty. 4

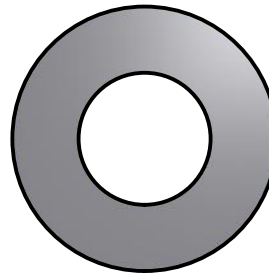

F-3277-00
5/16 Zinc Flat washer
Qty. 8



970406
5/16 Black Flat Washer
Qty. 10

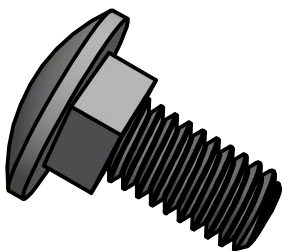

970498
5/16 Carriage Bolt
Qty. 2

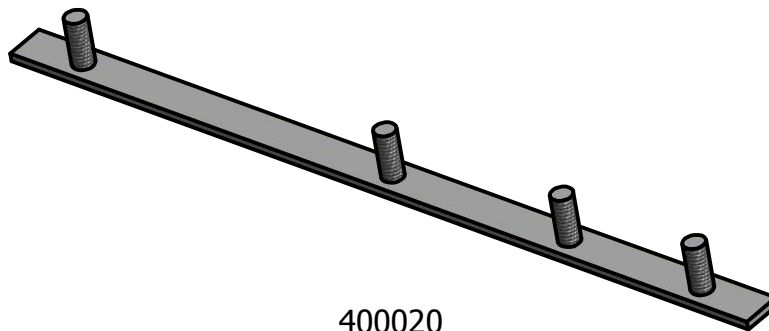

400020
Long Stud Plate
Qty. 2

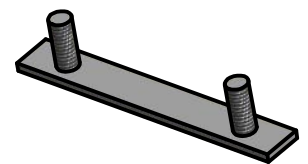

400009
Short Stud Plate
Qty. 2

Preparation Instructions

Careful

Kewaunee Scientific products are inspected and packaged carefully. As you open the carton, be careful not to damage the products inside if cutting tools are used.

Pre-Assembly

Some items have been factory assembled for your convenience. Hardware packs are included for each item requiring assembly.

Accessories

Task lighting, shelving, electrical components, and many other accessories are available to customize your work station to accommodate your needs. Check us out at www.Kewaunee.com to see all of the products we have to offer you!

Recommended Tools

The following tools are recommended, however we have included two standard wrench sizes needed to assemble the **EVOLUTION** workbench.

Screwdriver (#2 phillips type)

7/16" Open-End Wrench

1/2" Open-End Wrench

Level (for leveling worksurface)

Preparation

In order to properly align and assemble the **Evolution** work bench with ease you will need a clean flat work surface to do some of the assembling. It is recommended to assemble steps 1 through 8 on a clean floor to avoid damage to the work bench and to provide ease of assembly by one person.

Support

Visit www.Kewaunee.com for video on how to assemble the **Evolution** work bench or give us a call at **1-800-824-6626**

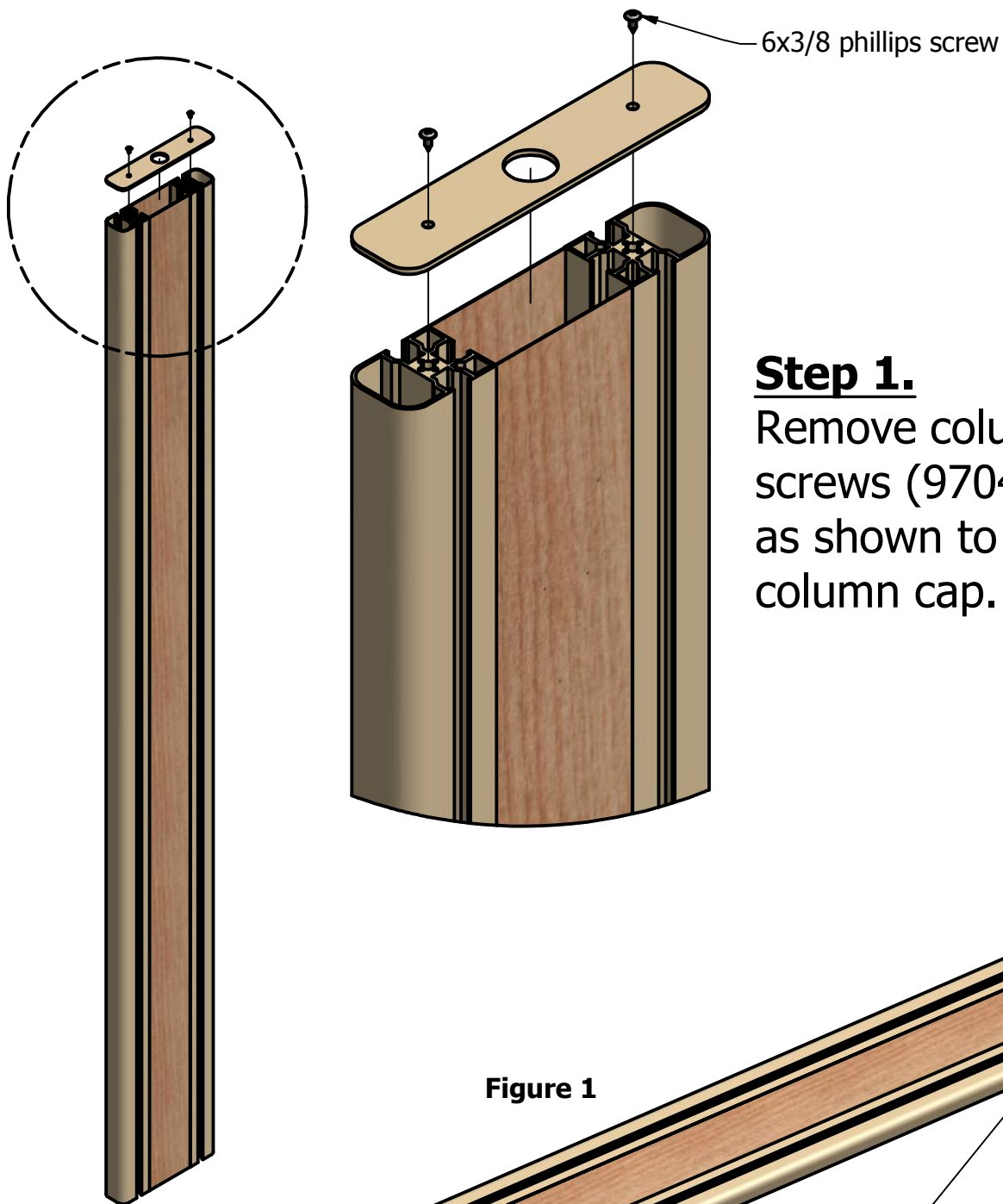

Step 1.

Remove column cap screws (970403) as shown to remove column cap.

Figure 1

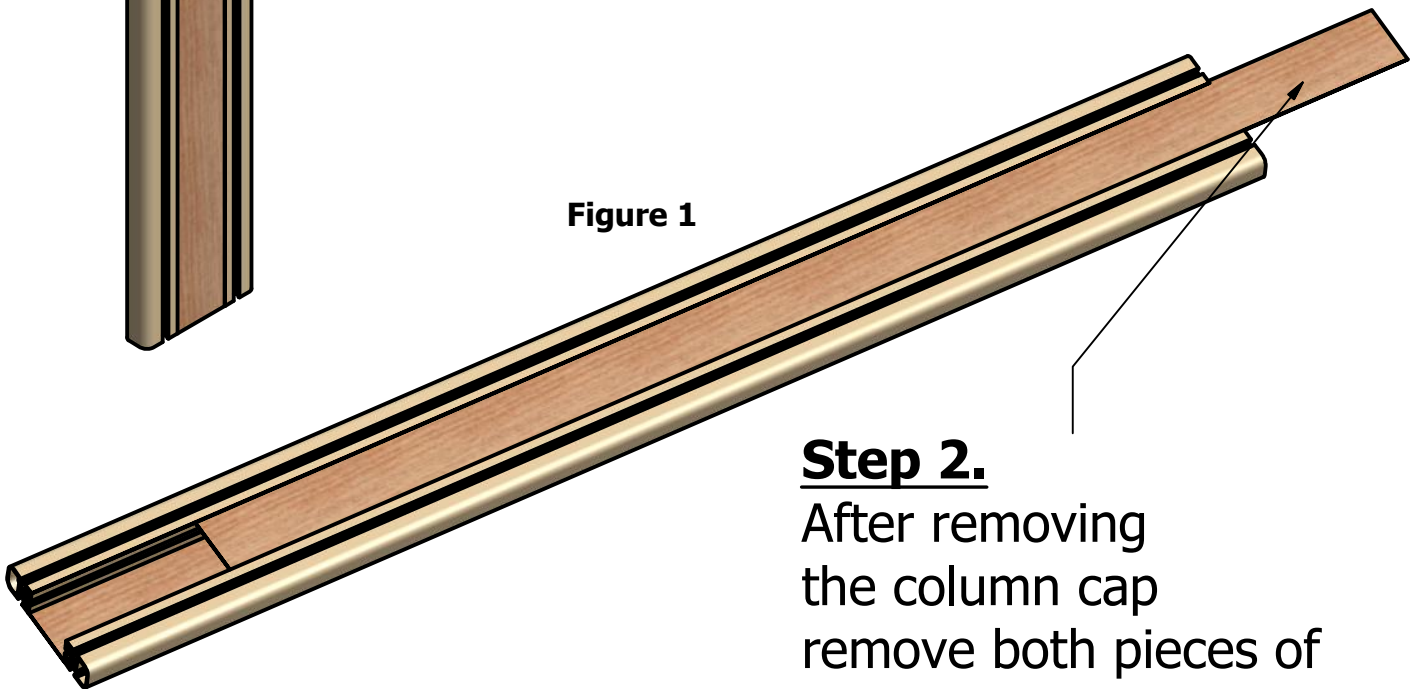

Step 2.

After removing the column cap remove both pieces of the column trim as shown in figure 1.

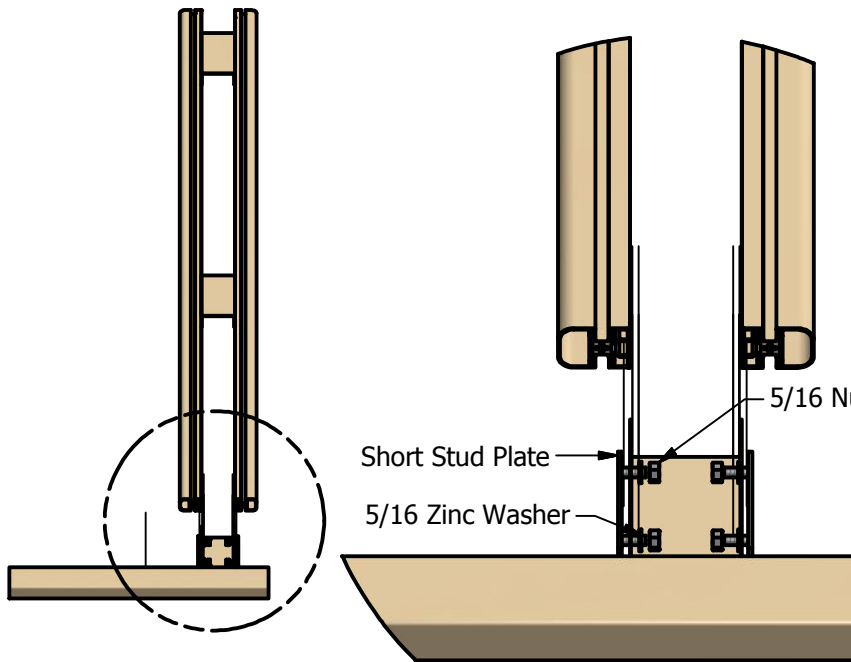

Step 3.

Insert short stud plates (400009) into Column leg bracket.

Assemble zinc washers (F-3277-00) and nuts (970014) onto the the short stud plates loosely (to allow ease of assembly between leg and column). Repeat for both column and leg assemblies.

Step 4.

Slide leg (with stud plates, washers, and nuts attached loosely) into the column. Align the stud plates with the inside of the track as shown in figure 2. After assembling both column and leg assemblies tighten nuts until snug then another 90° or 1/4 turn should be sufficient torque.

Note: 22 lbs of torque is recommended.

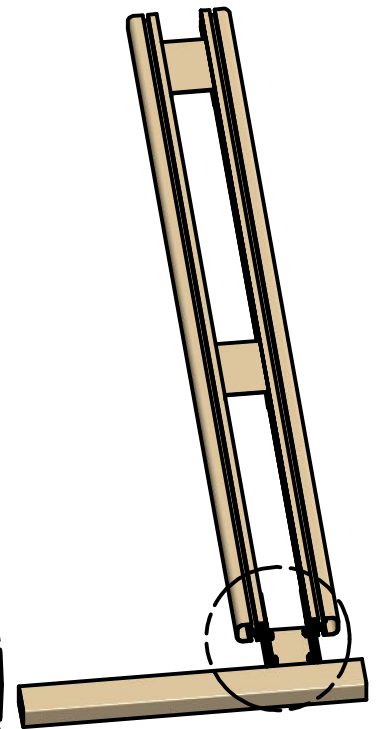
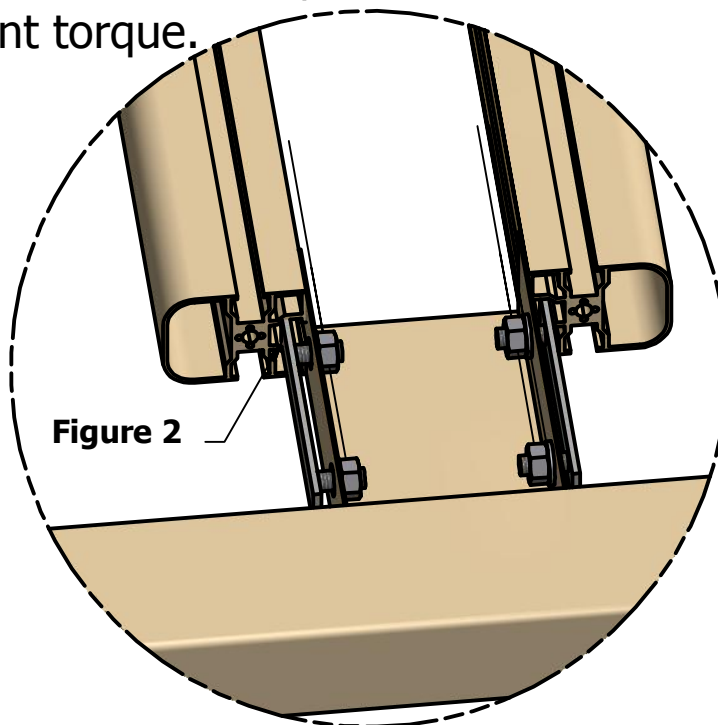

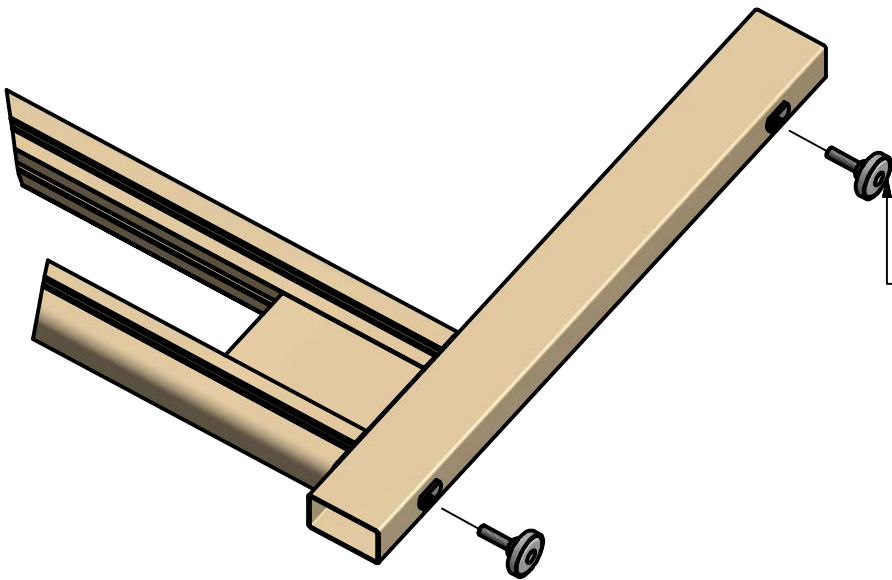

Step 5.

Install Leveling Glide on both column legs (990781) X 4

Step 6.

Insert Long Stud Plates (400020) and 5/16 Carriage Bolts (970498) into both columns in the track as shown in figure 3 and 4.

Note: For ease of assembly lay out each column and leg assembly faced opposing each other when inserting the long stud plate and the carriage bolt to ensure proper placement. **See page 8**

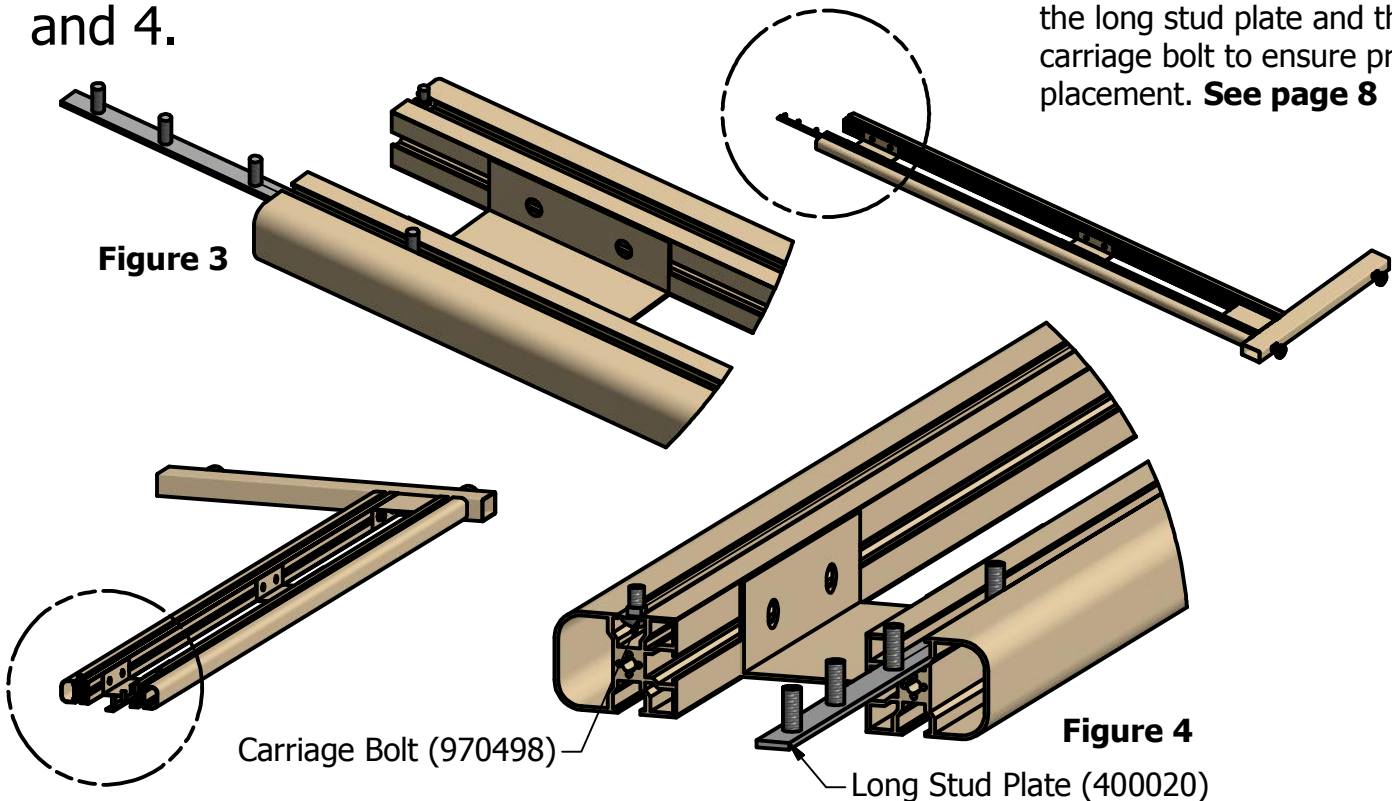

Step 7.

Reinstall column trim and caps from page 5 figure 1 into both columns.

The two column assemblies should look as shown before further assembly.

Left Column

Right Column

Step 8.

Insert column cap plug (990503) into both columns.

Column Cap Plug (990503)

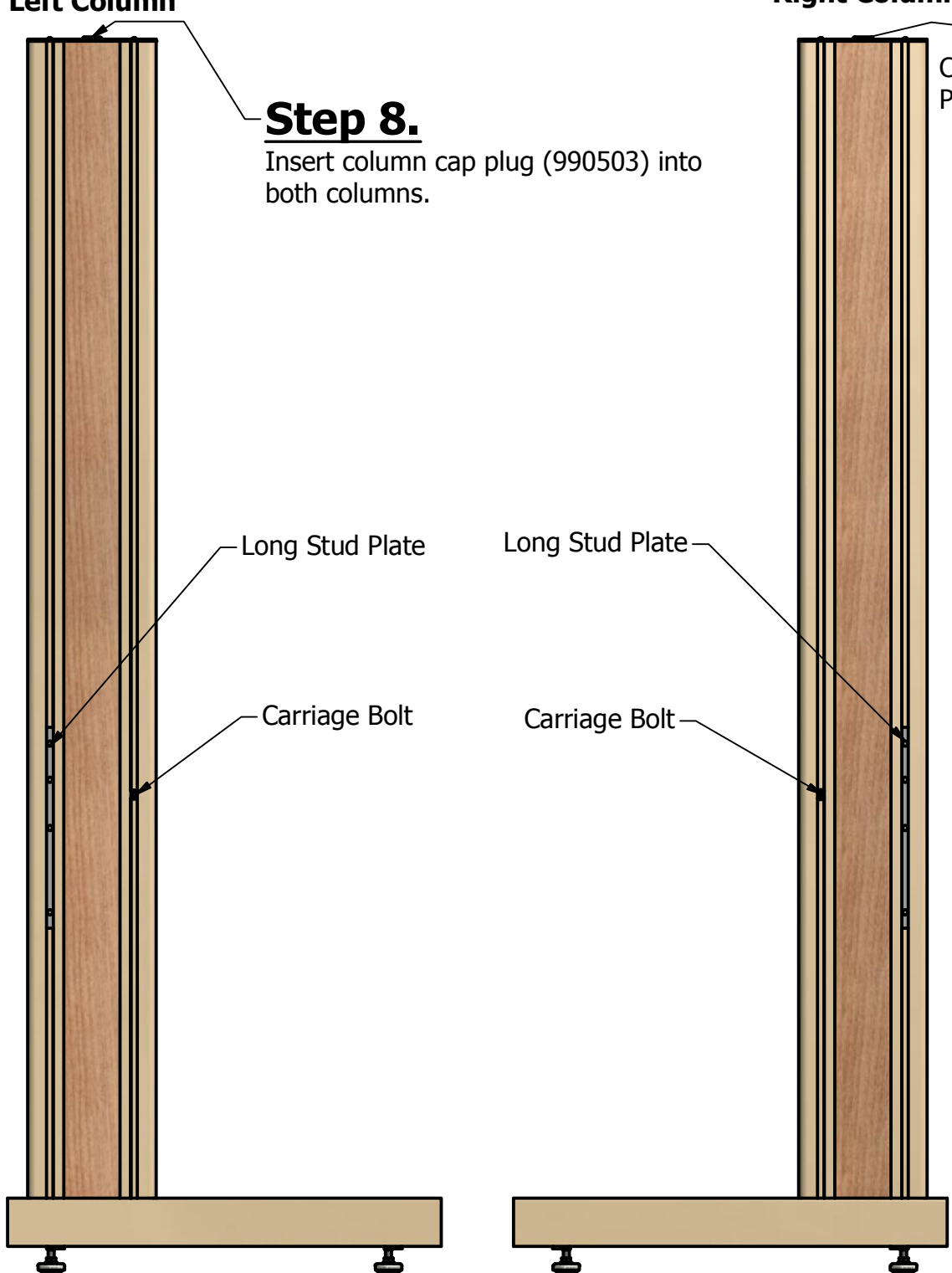

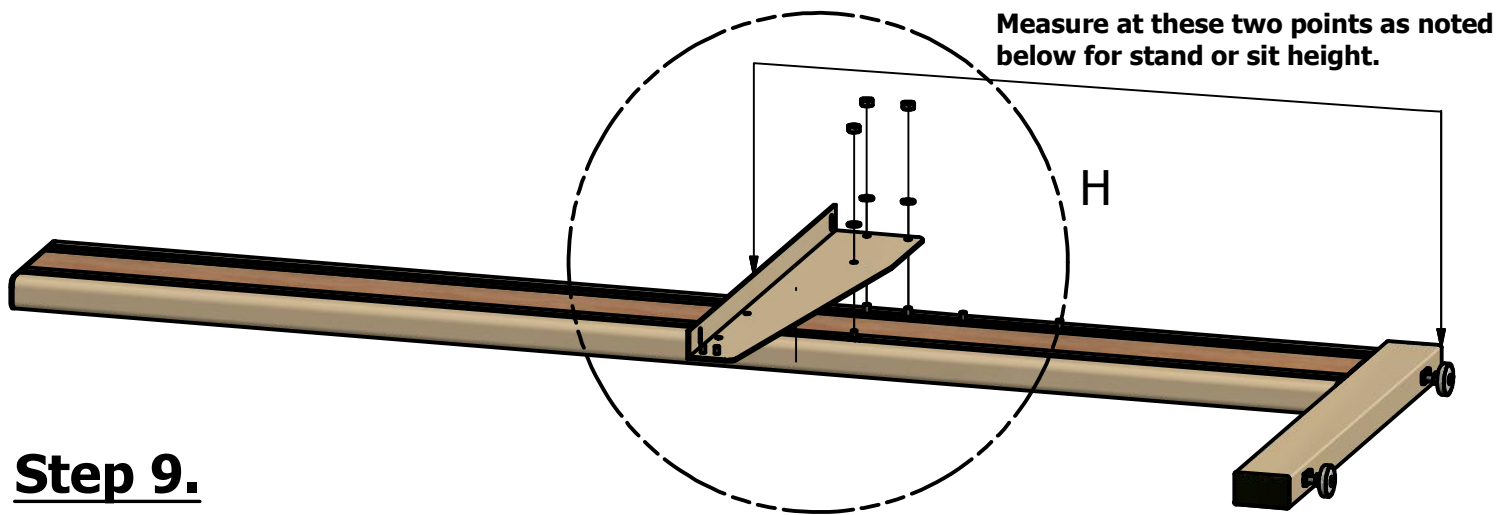

Step 9.

Assemble Table Top Support to column as shown using three black washers (970406) and three hex nuts (970014). Repeat for other column.

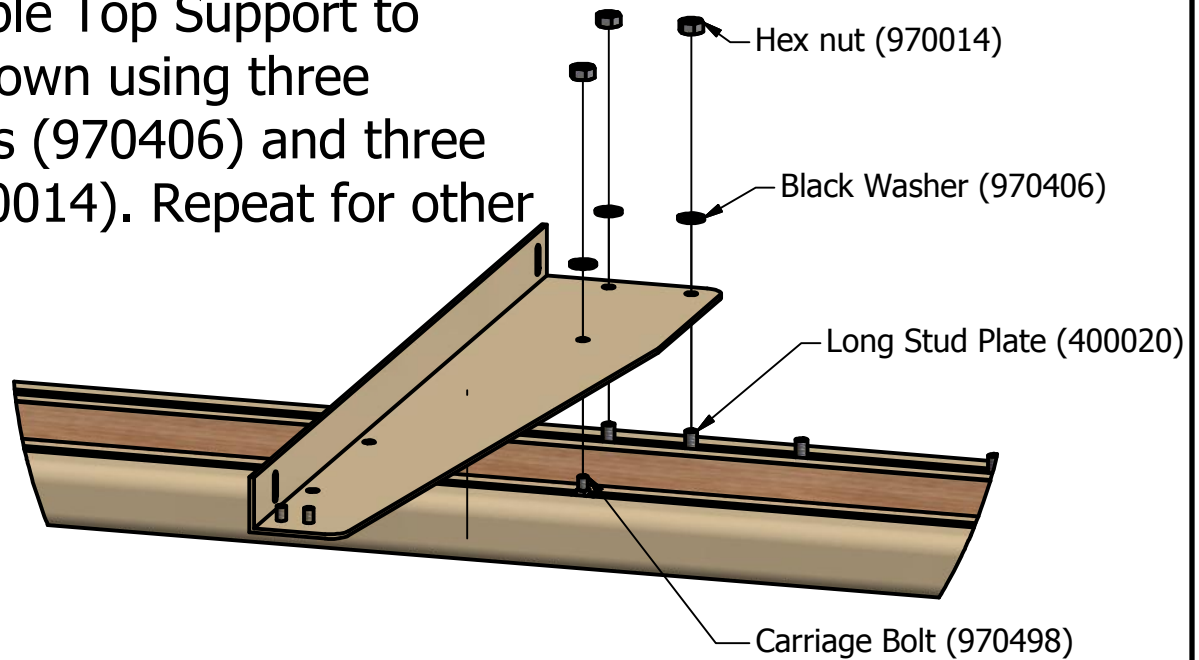

Note:*For sitting height measure 31 1/2" from the bottom of the leg to the top of the support

*For standing height measure 37 1/2" from the bottom of the leg to the top of the support.

Step 10.

Assemble the modesty panel to the column as shown. Align the holes in the modesty panel with the bottom studs of the stud plate. Fasten the modesty panel using two black washers (970406) and two black acorn nuts (970405).

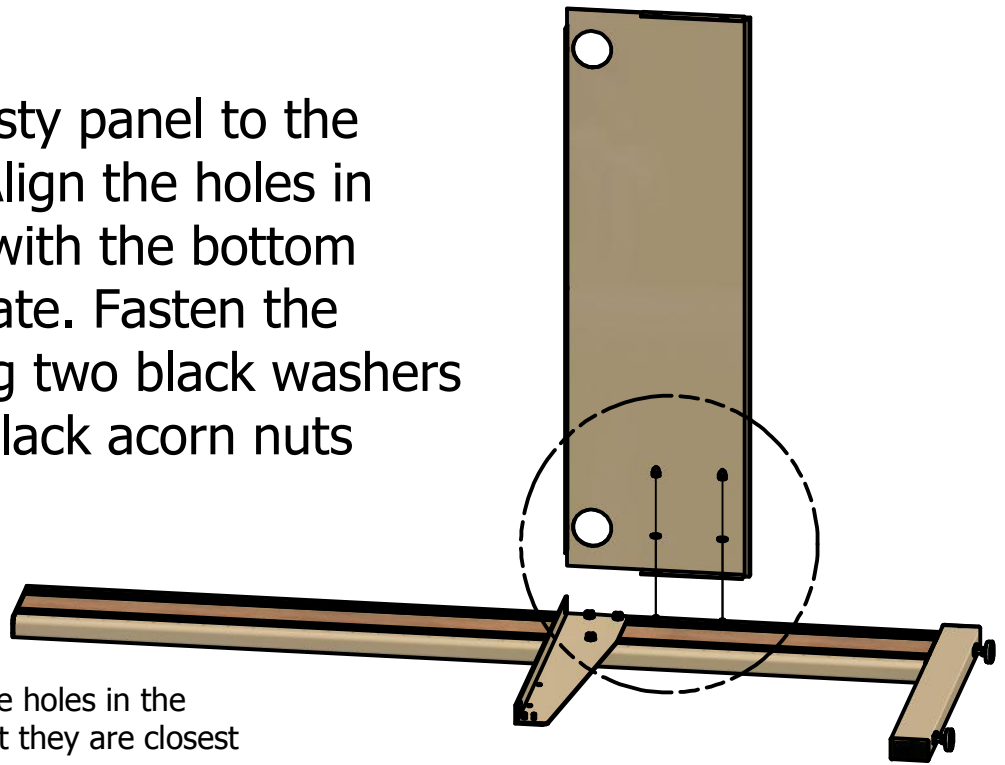

Notice the placement of the holes in the modesty panel. Ensure that they are closest to the support as shown.

Install Modesty Panel Insert

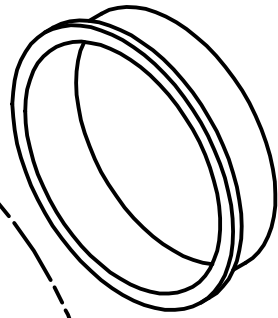
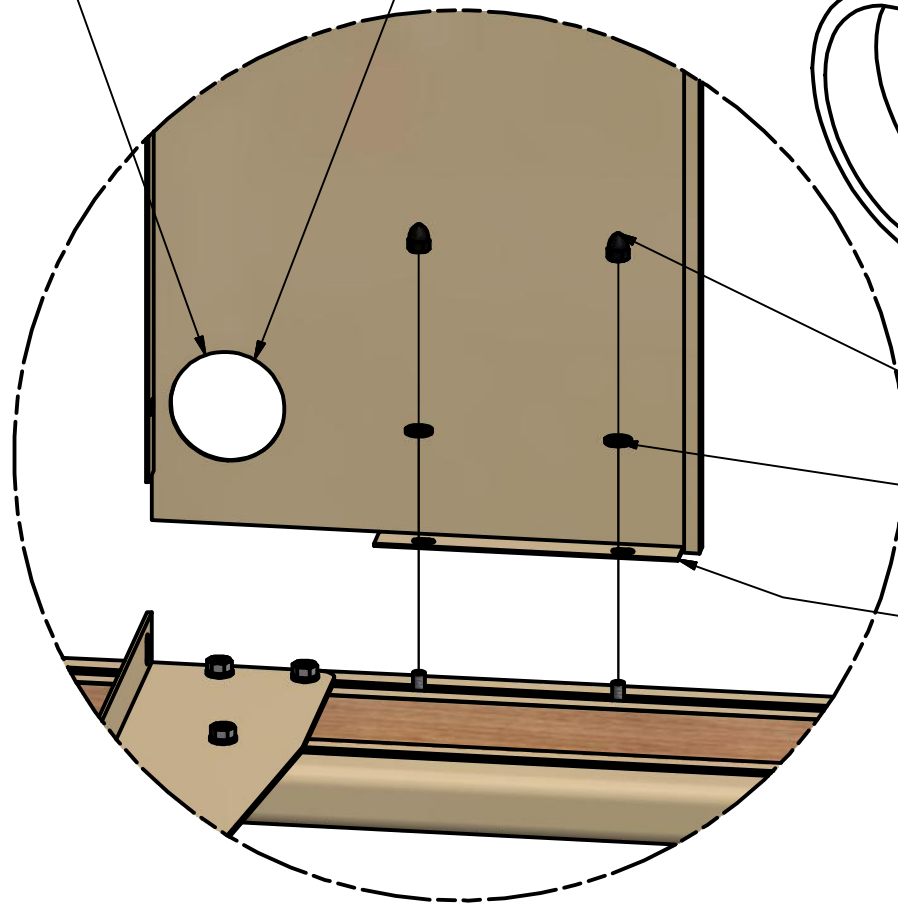

Black Acorn Nut (970405)

Black Washer (970406)

Notice the flange facing toward the front of the column.

Note: 22 lbs of torque is recommended.

Step 11.

Assemble the remaining column and leg assembly to the other end of the Modesty panel.

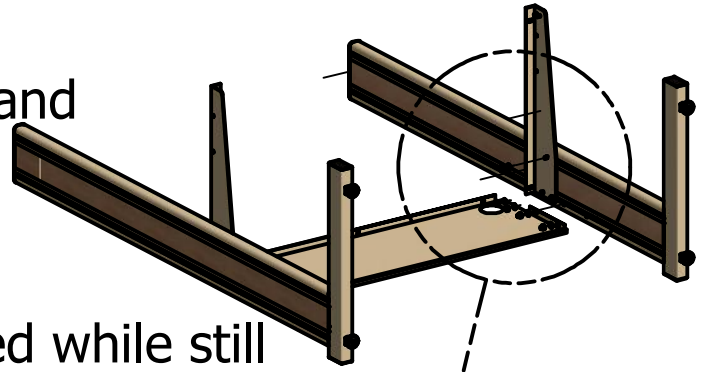

Note: This step is best assembled while still lying on the floor however with assistance this can be done standing up to avoid scratching part surfaces.

Step 12.

Assemble the apron as shown. Fasten using four tensilock nuts (970434).

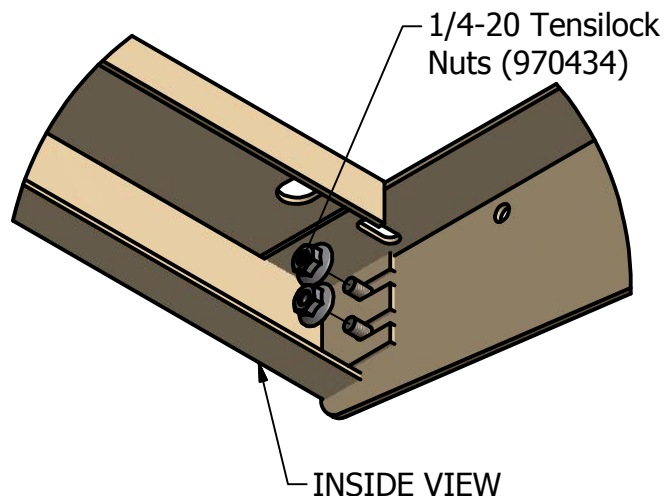
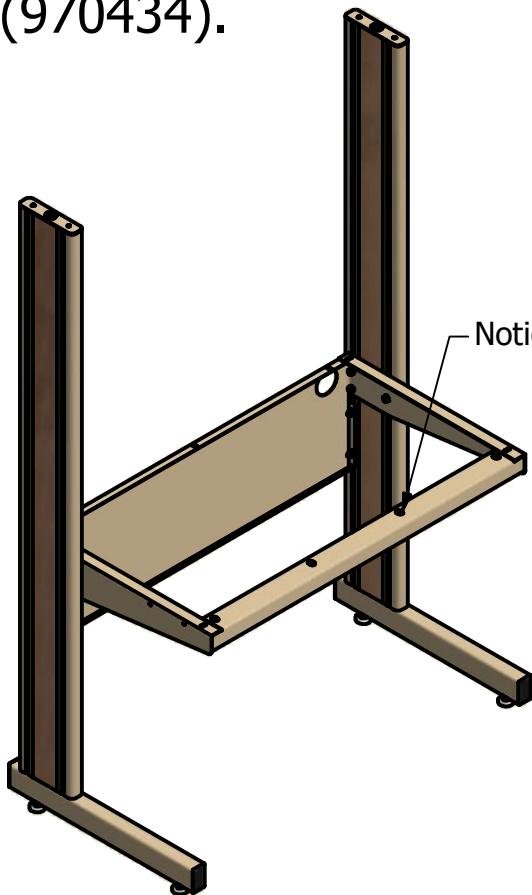
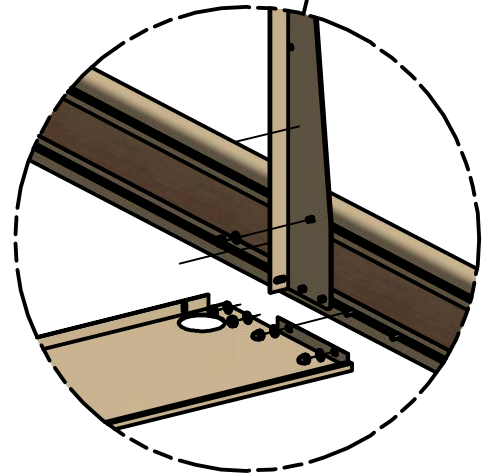

FINISH

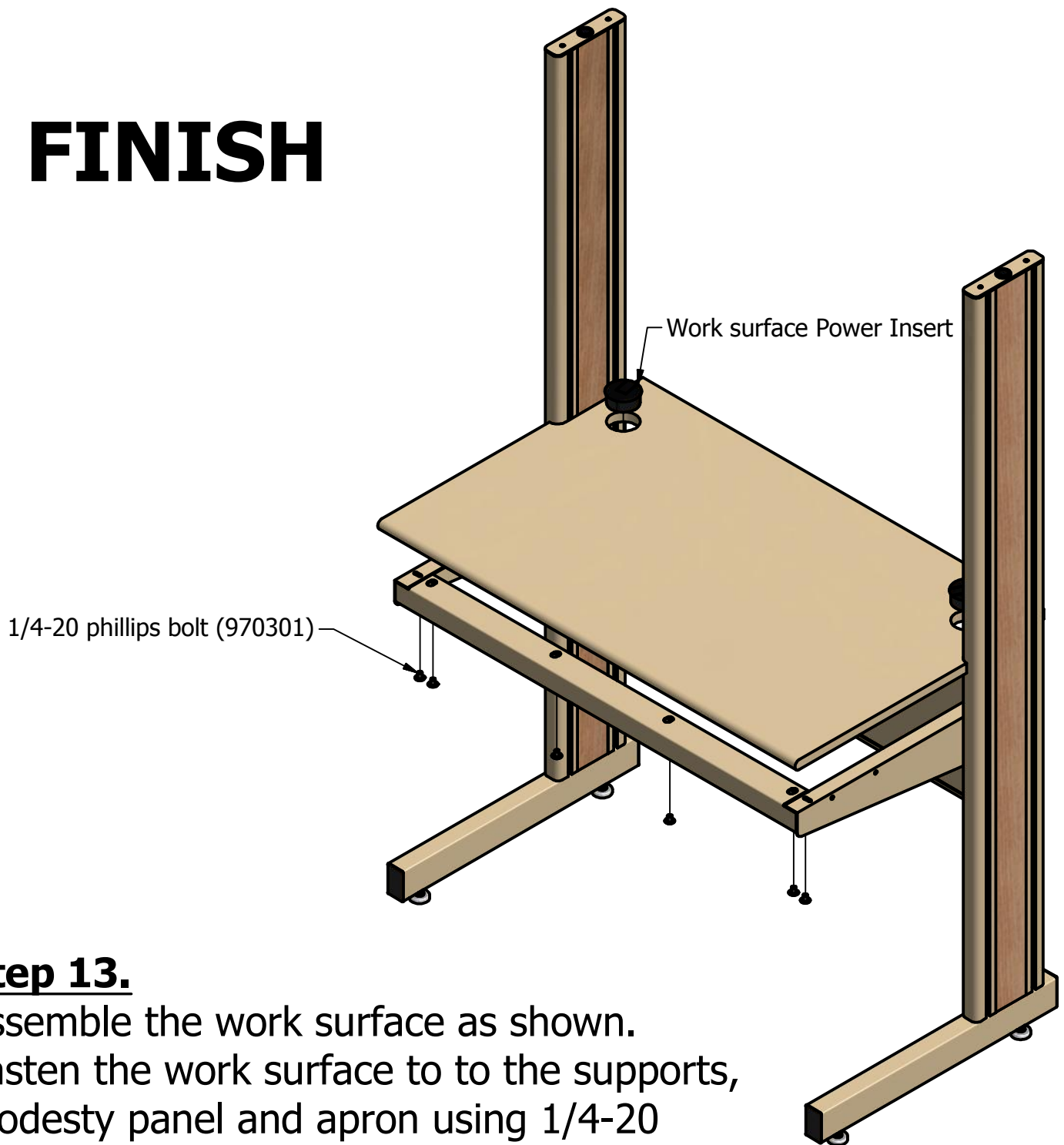

Step 13.

Assemble the work surface as shown. Fasten the work surface to the supports, modesty panel and apron using 1/4-20 phillips bolts (970301). Insert work surface power inserts.



CUSTOM PRODUCTS & SERVICES INC.

6286 Claude Way E., Inver Grove Heights Mn, 55076

PH: 888-444-1202 (Toll Free) or 651-452-0113 Fax: 651-452-2264

E-MAIL: Info@custom-products.com

Website: www.custom-products.com

"YOUR SOURCE FOR WORKPLACE SOLUTIONS"

Page 12